

# Jami Lin's Personal Success Map Feng Shui Recommendations

Expand your Natal Map with  
Flying Star Suggestions from [Yearly](#), [Monthly](#), and [Daily](#) Energies.

## General

*Please expand descriptions of the energetic attributes as they fit your lifestyle, needs, and desires. I invite you to tap into your intuition and add your creativity to the suggestions.*

In your hand is *the finest, most comprehensive Feng Shui map available anywhere*. It is a Feng Shui master's customized map specific for you (birth energies) and your home (inherent directional energies) with suggestions for each room. *Your Personal Success Map reading provides all the information that I professionally use when providing a personalized and comprehensive Natal Feng Shui analysis.*

To best take advantage of this masterful map, may I suggested that you spend time to understand each of the three energetic aspects one at a time. The more time spent understanding your Personal Success Map, the more your Feng Shui will grow. (I still study mine especially when the Yearly energies change.) The more you combine the energies (with the [Yearly](#) and [Monthly](#) maps), experiment with the suggestions, and track your life experience, the better you will make the best, holistic, and compromised Life-Enhancing decisions with all the aspects in the exact same way that the masters do!

The Colors on your Personal Success Map around the parameter indicate each:

- Directional Sector
- Element (and its color) of each Directional Sector:
  - North (Water/Blue)
  - Northeast (Earth/Yellow)
  - East (Wood/Green)
  - Southeast (Wood/Green)
  - South (Fire/Red)
  - Southwest (Earth/Yellow)
  - West (Metal/Gray)
  - Northwest (Metal/Gray)
  - The Tai Chi which in the Center has no direction is (Earth/Yellow)

**BONUS!** To learn more about each Element, enjoy this [comprehensive Elements-at-a-glance page](#).

*In case you need help... To review your custom Personal Success Map in its complete masterful detail, I too would need to give your map and floor plan some focused consideration. I have years of experience reading floor plans and these Feng Shui maps. In most instances, a personalized, professional reading will take about an hour (and that includes your questions too). I would be happy to provide your best compromised Life-Enhancing, result-based solutions.*

*A professional analysis is also the best way to cut through the "learning curve" as well as have you learn from the masterful benefits of my experience. **If you have Feng Shui questions and would like a [site or phone/Skype](#) consultation, it would be my pleasure to take good care of you.***

There are three different Natal Energies on your customized Natal Personal Success Map:

1. Your House's Inherent Energy to support your Life Desires
2. Your Personal Natal Energy defines your Personal Directions (determined by your birth year).
3. Your House's Natal Energy or Natal Flying Star Energy (based upon when you moved in and direction your house is facing).

## The Natal Energies: One at a Time

1. Life Desires By segmenting your home into nine-equal sections (as indicated on your Personal Success Map), you will discover where each of the nine Life Desires are located and how to activate them. They influence ambitions such as [Career](#), [Self-Cultivation](#), [Family](#), [Wealth](#), [Fame](#), [Relationship](#), [Children](#), [Helpful People](#), and [Health](#).

**BONUS!** To learn more about the attributes of each Life Desire, [click on the links above](#).

To help you choose Life-Desire objects, the links on your Personal Success Map go to my personally-selected items that I hope you'll enjoy.

You can locate your Life-Desire areas on your Personal Success Map as written in the color green.

SE	S	
<p>burglary, Fire &amp; Injuries, Legal Issues. Reduce with <b>Water</b>.</p> <p>Worst Personal Fortunes: Pain &amp; Sickness. Reduce with <b>Water</b>.</p> <p>Best Personal Fortune: Wealth &amp; Success. 1st Best with <b>Water</b>.</p> <p>Best Finances &amp; Life</p>	<p>3. Bright Future, Full of Possibility &amp; Leadership. Enhance with <b>Water</b> and/or <b>Wood</b>.</p> <p>1. Inner Knowledge, Spirituality, Self-Cultivation, Wisdom &amp; Philosophy. Enhance with <b>Water</b> and/or <b>quiet Metal</b>.</p> <p>Longevity &amp; Good Relationships. 3rd Best <b>Fame Recognition &amp; Public Position</b>.</p>	<p style="writing-mode: vertical-rl; transform: rotate(180deg);">S</p>
<p>Worst Professional Success, Fame &amp; Wealth. Enhance with <b>Water</b>.</p>	<p>5. Worst Personal Misfortunes: Professional Failure, Possible Disaster.</p>	

EXAMPLE: The Life-Desire is the South sector (highlighted in green) is **Fame: Recognition & Public Position**

PS: your map will print beautifully. I had to enlarge and reduce the resolution of this example for this PDF file.

All aspects of your Life Desires are influenced by:

- How much time you spend in each area.
- How much you activate the Life-Desire Energies by placing decorative items in the locations as suggested by your map. (Use the links on the previous page for ideas too.)
- The other two Natal Energies: Your Best Directions & Flying Star Energies (both included on your Personal Success Map).
- The [Yearly](#) Flying Star Influence.
- The [Monthly](#) Flying Star Influence.

## 2. Personal Directions

Your Personal Success Map indicates your four Best Directions (shaded in yellow for quick reference) and your four unfavorable directions.

You can locate your Personal Directions on your Personal Success Map as written in the color **blue**.

The Personal Direction number and its Chinese are written in the center of your map indicate your Kua number (based upon birth year) along with your personal element.

SE	S	
<p>urglary, Fire &amp; Ince, Legal Hems. Reduce with <b>Water</b>.</p> <p>orst Personal ortunes: Pain &amp; ness. Reduce with <b>Metal</b>.</p> <p>ty &amp; Success. 1st</p> <p>ice Finances &amp; Life</p>	<p>3. Bright Future, Full of Possibility &amp; Leadership. Enhance with <b>Water</b> and/or <b>Wood</b>.</p> <p>1. Inner Knowledge, Spirituality, Self-Cultivation, Wisdom &amp; Philosophy. Enhance with <b>Water</b> and/or quiet <b>Metal</b>.</p> <p>Longevity &amp; Good Relationships. 3rd Best</p> <p>Fame Recognition &amp; Public Position</p>	S
<p>rest Professional ession, Fame &amp; ith. Enhance with <b>Water</b>.</p>	<p>5. Worst Personal Misfortunes: Professional Failure, Possible Disaster.</p>	

EXAMPLE: his person's Personal-Direction Energy in the South is  
**Longevity & Good Relationships. 3<sup>rd</sup> Best**

The key to using your Best Directions:

- When sitting or standing, make sure your chest is facing one of your best directions. In other words, sit so you receive energy coming toward your chest. You will have one of your Best Directions directly in front of you.
- When sleeping or laying down, make sure the top of your head is pointing toward one of you Best Directions.
- Avoid sleeping or sitting facing in any unfavorable direction.

Ideal Feng Shui (in the order of priority) is to position your most significant:

- Furniture in one of your Best Directions.
- Rooms (entry, bedroom, kitchen, and office) in one of your Best Locations.

## Considerations about Personal Directions: Location & Direction

With Best Directions there is a very important difference between sleeping, sitting, and standing Direction and Location.

- Direction refers to furniture placement. Direction identifies the position of your body while standing, sitting or sleeping. EXAMPLE: When you are sitting in your desk chair, your chest is facing (and receiving energy) from the Direction energy in front of you.

Furniture such as your desk chair, stove, bed, and any major sitting, standing, or sleeping furniture should be facing one of your Best Directions.

With the rooms that you use most often, make sure you sit facing, stand-facing, and sleep with your head pointing toward favorable Personal Direction energies.

- Location is an actual space or a room. EXAMPLE: Your bed (furniture that should be facing a good Direction) is located in the bedroom. The bedroom is the Location.

All rooms or areas that you spend considerable time such as your entry, bedroom, kitchen, and office should be located in one of your Best Personal Locations. (EXAMPLE: if your best directions are N, S, E & SE, try to have your entry, bedroom, kitchen, office, and any other important area(s) located in the N, S, E & SE rooms of your home). Because no house is perfect, as with all aspects of Feng Shui, compromise may be required.

*Ideal Example: Your desk chair should be positioned to face one of your four Best Directions and your office should be located in a Best Direction Location. (And as much as possible, combine with good Flying Star Direction and Location.)*

Always prioritize your Facing Direction (instead of Location) because that is how you receive energy through your body.

Never sit/stand/sleep facing your 3<sup>rd</sup> and 4<sup>th</sup> worst Personal Directions especially when there are also facing unfavorable:

- Natal Flying Stars
- [Yearly](#) Flying Stars
- [Monthly](#) Flying Stars

All aspects of your Personal Directions are influenced by:

- How much time you spend in each area:  
Direction & Location.
- The other two Natal Energies:  
Flying Star and how much you activate the Life-Desire Energies.
- The [Yearly](#) Flying Star Influence.
- The [Monthly](#) Flying Star Influence.

## Flying Star Energies

How to read your Natal Flying Star Energies:



If a room is active (entry, living, dining, family, kitchen, office) use information indicated with a sun graphic. The active (or Yang) energy will take precedence:

“Sun” energies influence  
External Expressions, Outward Success & Finances.



If room is quiet (bedroom or meditation) use information indicated with moon graphic as the quiet (or Yin) energy will take precedence:

“Moon” energies influence Relationships,  
Family Harmony, Health & Internal Expressions.

You can locate Sun & Moon Natal Flying Star Energies on your Personal Success Map with the sun & moon graphics and black text.

SE	S	
Burglary, Fire & Injuries, Legal Issues. Reduce with <b>Water</b> . Worst Personal Fortunes: Pain & Grief. Reduce with <b>Water</b> . Wealth & Success. 1st Best Prosperity & Wealth.	3. Bright Future, Full of Possibility & Leadership. Enhance with <b>Water</b> and/or <b>Wood</b> . 1. Inner Knowledge, Spirituality, Self-Cultivation, Wisdom & Philosophy. Enhance with <b>Water</b> and/or <b>quiet Metal</b> . Longevity & Good Relationships. 3rd Best Fame Recognition & Public Position	S
Great Professional Success, Fame & Wealth. Enhance with <b>Water</b> .	5. Worst Personal Misfortunes: Professional Failure, Possible Disaster.	

The number before each energetic description comes from Feng Shui formulas. Because I have provided result-based suggestions, you do not need to understand the numbers to benefit.

If interested in learning about Flying Star numbers, I explain them in my [9-week Home Study Master's Course](#) (Secrets [#8](#) & [#9](#)).

Even though the specific quiet (moon) or active (sun) energy takes precedence depending on the activity of an area, both energies in combination influence each area.

## Considerations for Natal Flying Star Energies

### Front Door Location/House Facing Direction



Location & Direction: Your Natal Flying Stars is ideal when you enter from a good Direction energy and through a good Location energy.

- Direction refers to the direction your house is facing. The direction your house is facing is determined by standing outside the front door, with your back on the door. Whichever direction your eyes are looking, is the direction your house is facing.

This house-facing directional, sun/active energy is the influence that you bring in with you and carry throughout your home in the same way an over-perfumed person leaves their scent trail. The energy that you enter and “musk your home” with influences all others.

If you have favorable Natal energies, excellent! Make them even stronger by activating them with the Personal Success Map element suggestions.

If unfavorable:

- You can reduce the energy with the Personal Success Map element suggestion. Please note that you cannot “cure” energy, the impact will be lessened but they will still exist.
- Better yet, it is best to enter through another door especially when unfavorable Natal Energy is combined with unfavorable Monthly and/or Yearly energy. *If unfavorable energies are very strong, please use another door during seriously unfavorable cycles to reduce the possibility of sickness and/or misfortune.*

Remember, if you use an entry other than the front door (such as side or garage door), you will be carrying in the directional sun/active energy of the door that you use. Make sure it has good Best Direction & Flying Star energies.

- Location is the actual area or sector that you walk through.

SE	E	NE

House Facing East

ADVANCED EXAMPLE: Let's say your house is facing East.  
If your door is:

- In the center of your home's front wall, you are walking through the East Location and carrying in the Directional energy of the East.
- On the right of your home's front wall, you are walking through the Northeast Location and carrying in the Directional energy of the East.
- On the left of your home's front wall, you are walking through the Southeast Location and carrying in the Directional energy of the East.

While both Location and Direction Energies holistically combine, Direction has the stronger influence.

When your architecture doesn't allow for both good Direction and Location:

- Prioritize Direction over Location
- If your Natal facing direction and entry location is favorable or unfavorable, activate or reduce it (respectively) with the suggestions on the Personal Success Map.

Never enter bringing in the Natal energies of "Worst Personal Misfortunes and Sickness/Poor Health Energies" especially when they are also facing unfavorable:

- Personal Directions
- Yearly Flying Stars
- Monthly Flying Stars

Remember, you can reduce an unfavorable energy with the suggested reducing element and lessen its impact but not eliminate it. The stronger the negative stars, the more it is suggested to use another entry until the bad cycle passes.

Conversely, activate favorable energies with the suggested enhancing element.



Active Locations/Active Facing Directions  
dining chair/dining room, TV chair/TV room,  
desk chair/office, stove/kitchen

There is a very important difference between sitting/standing Direction and Location.

- Direction refers to furniture placement. Direction is defined by the position of your body while standing or sitting.

Placement of your stove (stand facing good Flying Stars), desk chair, sofa, piano bench or any major furniture where you spend considerable time should be facing (to receive) good Natal Flying Star Energies.



Graphic: Courtesy of *Buy your Home Smarter*

With the rooms that you use most often, make sure you sit facing and stand facing toward favorable active/sun Natal Flying Star Energies.

- Location is an actual space or a room.

*EXAMPLE: Your desk chair (furniture) is located in the office.  
The office is the Location.*

All active rooms or areas that you spend considerable time such as your entry, kitchen, and office should be located in good Natal Flying Star Energies.

*Ideal Example: Your desk chair should be positioned to face a good Flying Star Direction and your office should be located in a good Natal Flying Star Location. (And as much as possible, combine with good Personal Directions: Location and Direction.)*

Because no house is perfect, as with all aspects of Feng Shui, compromise may be required.

Always prioritize Facing Direction (instead of Location) because that is how you receive energy through your body.

Never sit or stand facing the Natal energies of “Worst Personal Misfortunes and Sickness/Poor Health Energies” especially when they are also facing unfavorable:

- Personal Directions
- [Yearly](#) Flying Stars
- [Monthly](#) Flying Stars

I am going to keep stressing this! You can reduce an unfavorable energy with the suggested reducing element and lessen its impact but not eliminate it. The stronger the negative stars, the more it is suggested to sit in another location and/or face a direction until the bad cycle passes. Activate favorable energies with the suggested enhancing element.



Quiet Locations/Quiet Facing Directions  
bed/bedroom, meditation chair/meditation room

There is a very important difference between sitting, sleeping or laying down Direction and Location.

- Direction: Direction refers to furniture placement. Direction identifies the position of your body while:
  - Sitting in your meditation chair, your chest should face (to receive energy from) a good Personal Direction and Flying Star energy in front of you.
  - Sleeping/laying down the top of your head or Crown Chakra should point toward a favorable Flying Star direction. (Learn about the Chakras in my 3<sup>rd</sup> book, [The Essence of Feng Shui](#) and [ColorAlchemy E-Triumphs](#).)

In the meantime, I invite you to Enjoy this **BONUS** [excerpt from The Essence of Feng Shui](#).)



Graphic: courtesy of *Buy your Home Smarter*

Placement of any quiet furniture where you spend considerable time should be facing (while sitting) or head pointing (while laying down) toward good Directions so you will receive good Natal Flying Star Energies

- Location: Location is an actual space or a room.

*EXAMPLE: Your bed (furniture) is located in the bedroom. The bedroom is the Location.*

All quiet rooms or areas that you spend considerable time should be located in good quiet/moon Natal Flying Star Energies.

*I deal Example: Your bed should be positioned so your head is pointing toward a good Natal Flying Star Direction and your bedroom should be located in a good Flying Star Location.*

Because no house is perfect, as with all aspects of Feng Shui, compromise may be required.

Always prioritize Facing Direction (instead of Location) because that is how you receive energy through your body.

Never sit, sleep or lie down facing the Natal energies of “Worst Personal Misfortunes and Sickness/Poor Health” Energies especially when they are also facing unfavorable:

- Personal Directions
- Yearly Flying Stars
- Monthly Flying Stars

One more time, it is that important—I only want you to have good fortune! You can reduce an unfavorable energy with the suggested reducing element and lessen its impact. The stronger the negative

stars, the more it is suggested to sleep facing another direction and/or in another location until the bad cycle passes. Activate favorable energies with the suggested enhancing element.

## Personal Success Map Details

For your convenience, here is my [comprehensive Elements-at-a-glance page](#) again.

To help you choose Element reducers and enhancers, the links on your map and with the individual values listed below go to my personally-selected items that I hope you'll enjoy.



### Sun Values

- 1: Intelligence, Academic, Scholarly, Professional Advancement  
Enhance energy with still or moving [Water](#) and/or quiet or moving [Metal](#)

*Water fountain or fish tank, painting of water, fresh water in a clear or blue glass/crystal bowl, fresh water in a metal bowl, metal wind chime, and/or blue or metallic accessories.*

2. Broken Bones & Bruises, Skin Problems, Professional Difficulties  
Reduce energy with quiet [Metal](#)

*The bigger/more metal the better, sculpture, bowl, use gray or metallic colors.*

*If front door/house facing direction or an area that you spend considerable time/facing, when combined with unfavorable Monthly and/or Natal energy, use another door/move to another location/facing direction to further reduce possibility of sickness/misfortune*

- 3: Bright Future, Full of Possibility & Leadership  
Enhance energy with moving or still [Water](#) and/or [Wood](#)

*Water fountain or fish tank, fresh water in a clear or blue glass/crystal bowl and/or plants- but not in bedroom, or anything made of wood, or has blue and/or green colors.*

- 4: Professional & Social Manipulations, Legal Problems  
Reduce energy with quiet [Metal](#)

*Metal sculpture, bowl, use gray or metallic colors.*

*If front door/house facing direction or an area that you spend considerable time/facing, when combined with unfavorable Monthly and/or Natal energy, use another door/move to another location/facing direction to further reduce possibility of related unfavorable luck.*

5. Worst Personal Misfortunes: Professional Failure,  
Possible Disaster  
Reduce energy with quiet [Metal](#)

*The bigger/more metal the better, sculpture, bowl, use gray or metallic colors.*

*If front door/house facing direction or an area that you spend considerable time/facing, when combined with unfavorable Monthly and/or Natal energy, use another door/move to another location/facing direction to further reduce possibility of sickness/misfortune*

6. Personal Power & Leadership, Distinction,  
and External Success  
Enhance energy with moving [Water](#) and/or big [Earth](#)

*Water fountain or fish tank, anything made of earth: ceramic, stone, earth tones and/or blue colors. A rose quartz would be beautiful and loving in your bedroom.*

7. Burglary, Fire & Violence, Legal Problems  
Reduce energy with still [Water](#)

*Painting of water, fresh water in a clear or blue glass/crystal bowl, fresh water in a metal bowl, and/or blue metallic accessories.*

*If front door/house facing direction or an area that you spend considerable time/facing, when combined with unfavorable Monthly and/or Natal energy, use another door/move to another location/facing direction to further reduce possibility of related unfavorable luck.*

8. Great Professional Success, Fame & Wealth  
Enhance energy with moving or still [Water](#)

*The bigger the better: water fountain, fish tank, fresh water in a clear or blue glass/crystal bowl, blue colors.*

9. Promotions, Accomplishments, Excellent Reputation  
Enhance energy with [Wood](#)

*Plants, any item made of wood and colors of green or fire objects-red colors and pointy shaped items.*

*This is "hot," strengthening energy! When combined with favorable Monthly energy, the influence is even better. Conversely, when combined with unfavorable Monthly and/or Natal energy, the influence may be "hotter" and more volatile. Observe and make necessary modifications.*



## Moon Values

- 1: Inner Knowledge, Spirituality, Self-Cultivation, Wisdom & Philosophy

Enhance energy with still [Water](#) and/or quiet [Metal](#)

*Painting of water, fresh water in a clear or blue glass/crystal bowl, fresh water in a metal bowl, and/or blue metallic accessories.*

- 2: Internal Organ Problems, Depression & Mental Sickness  
Reduce energy with quiet [Metal](#)

*The bigger/more metal the better, sculpture, bowl, use gray or metallic colors.*

*If bedroom and/or sleeping direction, when combined with unfavorable Monthly and/or Natal energy, reposition bed/sleeping direction or sleep in another room to further reduce possibility of sickness/misfortune*

- 3: Youthful, Creative & Spontaneous

Enhance energy with moving or still [Water](#) and/or [Wood](#)

*Water fountain or fish tank, fresh water in a clear or blue glass/crystal bowl and/or plants- but not in bedroom, or anything made of wood, or has blue and/or green colors.*

- 4: Family Disharmony & Pressure, Marital Indiscretions  
Reduce energy with quiet [Metal](#)

*Metal sculpture, bowl, use gray or metallic colors.*

*If bedroom and/or sleeping direction, when combined with unfavorable Monthly and/or Natal energy, reposition bed/sleeping direction or sleep in another room to further reduce the possibility of related unfavorable luck.*

- 5: Worst Personal Misfortunes: Pain & Sickness  
Reduce energy with quiet [Metal](#)

*The bigger/more metal the better, sculpture, bowl, use gray or metallic colors.*

*If bedroom and/or sleeping direction, when combined with unfavorable Monthly and/or Natal energy, reposition bed/sleeping direction or sleep in another room to further reduce the possibility of sickness/misfortune*

- 6: Personal Ease, Graciousness, Inner Strength  
Enhance energy with big [Earth](#)

*Anything made of earth: ceramic, stone, and/or earth colors. A rose quartz would be beautiful and loving in your bedroom.*

- 7: Arguing, Bickering, Isolation & Bone & Teeth Problems  
Reduce energy with still [Water](#)

*Painting of water, fresh water in a clear or blue glass/crystal bowl, fresh water in a metal bowl, and/or blue metallic accessories.*

*If bedroom and/or sleeping direction, when combined with unfavorable Monthly and/or Natal energy, reposition bed/sleeping direction or sleep in another room to further reduce the possibility of related unfavorable luck.*

- 8: Great Honor & Integrity, Social Status, Spiritual Growth  
Enhance energy with big [Earth](#)

*Anything made of earth: ceramic, stone, and/or earth colors. A rose quartz would be beautiful and loving in your bedroom or a little fire-red colors and pointy shaped items.*

- 9: Stability, Strong Convictions & Reputation  
Enhance energy with [Wood](#)

*Plants, any item made of wood and colors of green or fire objects-red colors and pointy shaped items.*

*This is "hot," strengthening energy! When combined with favorable Monthly energy, the influence is even better. Conversely, when combined with unfavorable Monthly and/or Natal energy, the influence may be "hotter" and more volatile. Observe to make necessary modifications.*

## Decorative Suggestions for the Personal Success Map

Your Natal energies (Life Desires, Best Directions & Flying Stars) are never going to change (unlike [Yearly](#) & [Monthly](#) changing energies). Because they will always be the same for as long as you occupy the property, I recommend that you activate good Natal Energies and reduce the unfavorable ones when designing the "Big Stuff" first. When the "unchanging design" is completed, it will be easy to move a few items to enhance and support the ever-changing [Yearly](#) & [Monthly](#) Energies.

### "Big Stuff" Details:

- Identify the most logical rooms for each task based upon architecture and Natal Locations.
- Design the rooms and lay out your furniture to face your good Personal Directions (and your loved one's energies) and good Natal Flying Stars.
- Use fabrics, flooring, and wall colors to reflect enhancing and/or reducing the Natal Energies as suggested on your Personal Success Map. (Visit [HERE](#) if you need extra design help with the colors, textures, and shapes of the elemental suggestions.)
- Place major art and accessories to enhance and/or reduce Natal Energies (as suggested) as well as to activate [Life-Desires Energies](#).
- Combine energies using the best compromised solutions of all Natal Energies.

## (Optional & Suggested) Advanced Detailing

### Direction Elements

You may have wondered how to incorporate the Directional Elements (indicated by the colored edge of each directional sector). When you evaluate the Element enhancer or reducer for your Natal Flying Star Energy, consider what that Element will also do to the Directional Element. Make sure that both considerations are supported. (Discover the details of the most important 5 Element theory in Jami Lin's: [9-week Home Study Master's Course](#) - Secret [#5](#) and [Feng Shui Today](#))

### Macro & Micro Detailing

With all maps, maximize your Feng Shui even further by using Micro Energies. Each room is a "mini map" in itself with exactly the same nine-directional locations and energies of your Natal Energies (Life Desires, Best Directions & Flying Stars), as well as [Yearly](#) & [Monthly](#) Energies.

This graphic identifies how your home is divided into 9-equal areas and how each room can also be divided into 9-equal areas.

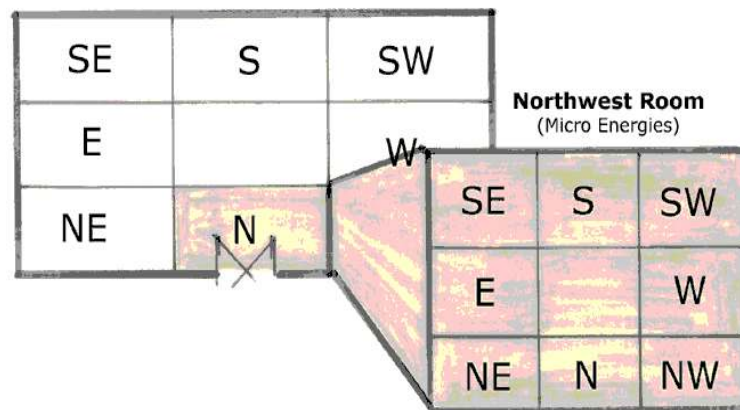

Each rectangle in the house is subdivided into each of the eight directions and center area too. Each room is directionally oriented in exactly the same way as your Personal Success Map. Directional Energy is always the same whether you are evaluating the Macro Energies (the entire house) or Micro Energies (each individual room). In other words, the South micro rectangle of each room has the Natal energies of the South. Magnetic energy and compass direction are always consistent.

- Detail specific rooms, especially those used most often and most significant to what you want to accomplish (bedrooms, office, etc) using Natal Macro & Micro Energies as well as combined [Yearly](#) and [Monthly](#) Energies.

*EXAMPLE: If you have good Personal Directions and Flying Stars energy in the North, it is optimum to:*

- Have your bedroom in the North room of the house (Macro Location).
- Have your bed located in the North area of the room (Micro Location).
- Position the bed with your head pointing towards the North of the room (Micro Direction).

## Final Suggestions

- Layout significant furniture (desk, bed, stove-if possible, favorite dining & TV chair, etc) to sit/sleep in the best locations (Personal Directions & Natal Flying Stars) and to face your good (Personal Directions & Natal Flying Stars) directions in each room.
- A few masters even suggest that by overlaying a “micro-mini” map on significant pieces of furniture you will enhance or reduce energies. You can place appropriate enhancing or reducing desk accessories on your desk and/or Life-Desire accessories.
- Always combine [Yearly](#) & [Monthly](#) maps for a comprehensive reading and get maximum results the same way that the masters do!

[Order Monthly & Daily Maps and Mastery Membership for ONE Year and SAVE \\$40!](#)

Spend time getting to know your home with the Natal, Personal Success Map energies. You will find that you do have all the information that you need for a complete Natal analysis. Experiment, track your successes, and most of all have fun!

Wishing you only the BEST Feng Shui, from my heart to yours,

Love,

Jami Lin

Got more Questions?

Get Personalized Answers in three FAST and EASY ways!

1. Enjoy Jami Lin's [9-week Home Study Master's Course](#).
2. Read Jami Lin's Internationally-Acclaimed [books](#) , [videos](#), and [audio recordings](#).
3. Learn about your home and the depth of Feng Shui from my years of experience. Confirm You are on the right track.

Schedule a [site](#) or [phone/Skype](#) consultation to enhance your Feng Shui even more!

Check out all our *Make YOUR Life Work* programs

- [Deepen Love • Increase Wealth • Improve Health](#)
- [Raise Spirituality & Reduce Stress](#)
- [Look Younger: Natural, Anti Aging Skin Care](#)

For immediate access to additional offerings, visit [JamiLin.com](#), and Enjoy the:

- Mega-Tips: Home & Garden, Chakra & Bagua, Elements
- Jam-Packed Article Archive
- General, Monthly, Daily & Love-Match Horoscopes

## DISCLAIMER

Recommendations made in this publication does not prescribe the use of any techniques as treatment for physical, emotional, or medical problems.

This information is provided with our most positive intentions to help you in your quest for emotional and spiritual well-being.

Neither the authors, publishers, programmers, and/or its affiliates assume any responsibility for your actions.

## ALL RIGHTS RESERVED

No part of this publication may be reproduced by any mechanical photographic, audio, or electronic process, nor may it be transmitted or otherwise copied for public or private use - other than for "fair use" as brief quotations in articles and reviews - without prior written permission of the publisher.

Copyright Violation as protected by international law.  
Thank you for your cooperation

## Special Offers



Please see  
Special Offers  
"Order Form"  
on the next page

and these  
SPECIAL links!

A promotional banner with a yellow background and a red diagonal banner in the top-left corner that says "FREE". The text "Personal Success Map" is in large white font. Below it, in a white box, is the text "with 1-yr Mastery 'House Astrology' Membership and Yearly Success Map". At the bottom, "Click Here" is written in red.

A promotional banner with a yellow background and a red diagonal banner in the top-left corner that says "FREE". The text "28 Day E-Triumphs" is in large white font. Below it, in a white box, is the text "3-hr Daily Color Balance Video Triumph Oracle with ColorAlchemy Special". At the bottom, "Click Here" is written in red.

A promotional banner with a yellow background and a red diagonal banner in the top-left corner that says "FREE". The text "Feng Shui Today" is in large white font. Below it, in a white box, is the text "Essence of Feng Shui with Bagua/Chakra E-Book Special". At the bottom, "Click Here" is written in red.

A promotional banner with a yellow background and a red diagonal banner in the top-left corner that says "FREE". The text "Feng Shui Flash Cards" is in large white font. Below it, in a white box, is the text "with Unbelievable Half-Price Book Special". At the bottom, "Click Here" is written in red.

**CALL NOW: 800-EarthDesign (800-327-8437)**

Name \_\_\_\_\_ Phone: \_\_\_\_\_

Email \_\_\_\_\_ to receive electronic products Address \_\_\_\_\_ Zip \_\_\_\_\_ to process CC or ship items

Special \$	Regular \$	Products & Feng Shui: <a href="#">Phone Consultation</a> – <a href="#">Site Consultation</a>
<a href="#">special?</a> sometimes offered on site links!	\$90	<b><a href="#">Personal Success Map</a>, do-it-yourself Feng Shui consultation</b> sent electronically – effective as long as you occupy the property  1. What year were you born _____ 2. Where you born before Feb 4 <sup>th</sup> ? <u>yes/no</u> (circle) 3. When did you move into your home? <u>1984-2003</u> or <u>after 2/4/2004</u> (circle) 4. Which <i>direction</i> is your house facing? N, S, E, W, NE, NW, SW, SE (circle) Stand <u>outside</u> your home, with your back on the main door, whatever direction your eyes are looking is the direction your house is facing. 5. What <i>degree</i> is your house facing (optional) _____
<a href="#">special?</a>	\$38	<b><a href="#">Yearly Personal Success Map</a></b> – your yearly energies Which <i>direction</i> is your house facing? N, S, E, W, NE, NW, SW, SE (circle)
<a href="#">special?</a>	\$498 \$348	<b><a href="#">Feng Shui Home Mastery Course &amp; GRADUATE Certification</a></b> <b><a href="#">Feng Shui Home Mastery Course &amp; FOUNDATION Certification</a></b> includes international recognition - electronically sent/processed <b>Easy Pay available with <a href="#">online ordering</a></b>
<a href="#">special?</a>	\$144	<b><a href="#">Feng Shui Home Mastery Course (Easy Pay available online)</a></b> Basics thru Flying Stars - lessons ONLY sent electronically
<b>\$139-all 4 save \$53</b> individually → → →	<b>\$192</b> \$9 \$30 \$99 \$54	<b><a href="#">ColorAlchemy: Self Mastery with Color: Special</a></b> • <a href="#">Triumph Oracle Deck</a> • <a href="#">award-winning ColorAlchemy book 272 pp in glorious color</a> • <a href="#">ColorAlchemy 4-hr Training DVD</a> • <a href="#">ColorAlchemy E-Triumphs, 28-day online DailyColor course (Easy Pay available)</a> (E-Triumphs on Training DVD: you can substitute <a href="#">Personal Success Map</a> )
<b>\$45 - all 4 that's below wholesale!</b> individually → → →	<b>\$98</b> \$20 \$18 \$25 \$13 \$22	<b><a href="#">Feng Shui Collection SPECIAL: Books/DVD/CD</a></b> • <b>SPECIAL BONUS: Free Feng Shui cards: BOTH <i>Basic &amp; Earth Series</i></b> • <a href="#">Feng Shui: book</a> - featured in Book-of-Month Club • <a href="#">Feng Shui Today: Video-DVD &amp; PBS-TV pilot</a> - featured in Book-of-Month Club • <a href="#">Essence of Feng Shui</a> • <a href="#">Feng Shui Anthology: CD</a> all 40 master's articles!
<b>\$63 - all 4 immediate access!</b>	<b>\$96</b> \$54 \$15 \$ 9 \$18	<b><a href="#">E-Books: SPECIAL on all 4 (Easy Pay available online)</a></b> • <a href="#">ColorAlchemy E-Triumphs</a> • <a href="#">Feng Shui Today</a> • <a href="#">Essence of Feng Shui</a> • <a href="#">Feng Shui Anthology</a> (40 master's articles, over 400 pages -special: 20 articles/200 pages)
		<b>shipping &amp; handling on products to be mailed only</b> (circle 1): standard US or standard international \$23-for 1 item
<b>3 payment options</b>	<b>Total</b>	<b>PayPal: "send money" to <a href="mailto:J-L@JamiLin.com">J-L@JamiLin.com</a></b> mail: Jami Lin, 9 Riverfront Drive, Venice, FL 34293 <b>Visa/MC</b> _____ <b>exp</b> _____ <b>code</b> _____

**You will see your items charged to EarthDesign, Inc. Thank you for your order!**

Signature \_\_\_\_\_ need to ship anything? \_\_\_\_\_

office use: approval code \_\_\_\_\_ CC process date \_\_\_\_\_ ship date \_\_\_\_\_ Notes \_\_\_\_\_ (orderform.wpd)